



HYDROMINE™ LFC_7 Range Of Energy Dissipators

Overview:

The HYDROMINE™ LFC_7 energy dissipator is a custom designed piece of equipment that reduces the upstream pressure to the designed ratio at a specific designed flow rate.

The HYDROMINE™ LFC_7 energy dissipator has been developed to present a robust, simple and cost-effective method to reduce pressure at a set flow rate in open ended pipes. It will typically be used with a dam level control valve, or a column drain valve. The dissipator will ensure that the pressure is discharged from the open end at a safe pressure. The HYDROMINE™ LFC_7 energy dissipator will increase the life of the valve upstream of it as the valve will not be required to throttle or break pressure. The high wear task is undertaken by the dissipator.

Operating Conditions:

The HYDROMINE™ LFC_7 energy dissipator have a series of orifices that break pressure and reduce flow over each stage.

Noise Level:

The HYDROMINE™ LFC_7 energy dissipator is relatively quiet compared to other dissipators in the marketplace.

Dimensions:

Unit	Face to face dimensions (ANSI B16.10) (popular sizes only)									
	#150		#300		#600		#900		#1500	
	(mm)	(inch)	(mm)	(inch)	(mm)	(inch)	(mm)	(inch)	(mm)	(inch)
DN50 / 2"	303	8	267	10 1/2	292	11 1/2	368	14 1/2	368	14 1/2
DN80 / 3"	241	9 1/2	318	12 1/2	356	14	381	15	470	18 1/2
DN100 / 4"	292	11 1/2	356	14	432	17	457	18	546	21 1/2
DN150 / 6"	356	14	445	17 1/2	559	22	610	24	705	27 3/4
DN200 / 8"	495	19 1/2	559	22	660	26	737	29	832	32 3/4
DN250 / 10"	622	24 1/2	622	24 1/2	787	31	838	33	991	39
DN300 / 12"	699	27 1/2	711	28	838	33	965	38	1130	44 1/2
DN350 / 14"	787	31	762	30	889	35	1029	41	1257	49 1/2
DN400 / 16"	914	36	838	33	991	39	1130	44	1384	45 1/2

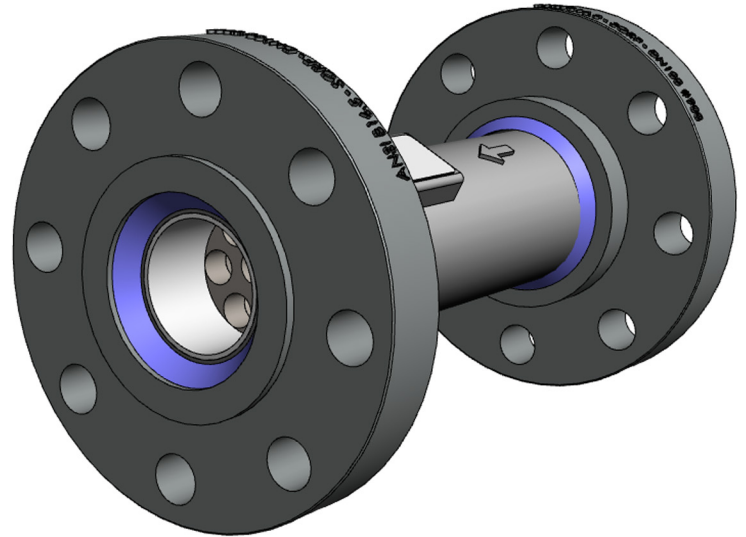

Design & Manufacturing Standards:

The HYDROMINE™ LFC_7 Energy Dissipator Range has been designed in accordance with various international standards as set out below:

ASME Boilers and pressure vessels design code

ANSI B16.10 API598

ANSI B16.34 ANSI B16.37

ANSI B16.5 ANSI N278.1

Available sizes: DN12 / 1/2" to DN1000 / 40"

Pressure rating: up to 25MPa / 3 626 psi

Face to face dimensions: ANSI B16.10 or other as per client requirement.

Available end connections: ANSI B16.5, BS4504, BS10, AS/NZS 4331.1 (ISO 7005-1)

DIN, All makes of grooved or ring joint couplings, HYDROMINE™ HMP U-Coupling,

HYDROMINE™ HMP_TE tapered couplings and other as per clients requirement.

Materials Of Construction:

Part Name	Material Specification
Body #1	ASTM A105 Grade B
Body #2	Hollow bar ST52
Stages	431 S/Steel hardened
Spacers	ASTM A105 Grade B
Stopper	Carbon steel